

# CALTRAIN ELECTRIFICATION



## BURLINGAME CROSSING CLOSURE NOTICE | May, 2022

### UPCOMING ACTIVITIES AND CLOSURES

From May 1 to May 20, Caltrain will be performing signal cutover work at 17 grade crossings in Burlingame and San Mateo. On May 7 and May 14, Caltrain will perform grade crossing cutover and installation work in Burlingame that will require the temporary closures of the **Bayswater Avenue, and North Lane** railroad crossings to vehicle and pedestrian traffic. The **Morrell Avenue Pedestrian crossing** will also be closed during construction.

**NOTE: Crossing gates will not be activated at all railroad crossings San Mateo and Burlingame during this time, but flaggers will be present to direct traffic through all other intersections.**

### BURLINGAME-TEMPORARY CROSSING CLOSURES

Bayswater, North Lane, and Morrell crossings:

- Saturday, May 7 at 12:01 a.m. to Sunday, May 8 at 8 a.m.
- Saturday, May 14 at 12:01 a.m. to Sunday, May 15 at 8 a.m.

### BURLINGAME CROSSING CLOSURES

Bayswater, North Lane, and Morrell crossings:

**Between May 15 to May 20, testing will occur that COULD result in additional closures. Please watch for traffic signs and flagging staff.**

Closure maps identifying closure locations are provided on the reverse of this notice. Detailed detour route maps will be available the week before actual closures and can be found at the following website: <https://calmod.org/resources/> under the Burlingame tab.

### CALTRAIN SERVICE INFORMATION

Temporary service changes in the weekday morning and late afternoon schedules (5:30-9 am and 3:30-7 pm) will be in effect. The work will require a reduction in peak-hour service and suspension of Baby Bullet service. The current 104 weekday trains will be reduced to 88. Weekday middays, evenings, and weekend service remain unchanged. For more information on service changes, please visit [www.caltrain.com/May2022](http://www.caltrain.com/May2022).

Trains are single-tracking through Broadway, Burlingame, San Mateo, Hayward Park, and Hillsdale stations for three weeks affecting passenger boarding. Riders using those stations should be sure to pay attention to signage and announcements to make sure they are waiting at the correct platform at the station.

### PROJECT OVERVIEW

Over the last decade, Caltrain has experienced a substantial increase in ridership and anticipates further increases in ridership demand as the Bay Area's population grows. Caltrain Electrification, scheduled to be operational by 2024, will electrify and upgrade the performance, operating efficiency, capacity, safety, and reliability of Caltrain's commuter rail service.

Caltrain electrification is a key component of the Caltrain Modernization Program and consists of replacing diesel-hauled with an electric train system for services between Fourth and King Street Station in San Francisco and the Tamien Station in San Jose. The project will include the installation of new electrical infrastructure and the purchase of electric trains.

### CONTACT INFORMATION

Caltrain has established a project information line and e-mail to record and respond to questions and comments from residents and stakeholders.



#### FOR MORE INFORMATION

 [calmod.org](http://calmod.org)

 Para traducción llama al 1.800.660.4287  
如需翻譯,請電 1.800.660.4287  
Cần dịch thuật, xin gọi 1.800.660.4287

#### CONTACT

MAIL: 2121 S. El Camino Real, Suite 300  
San Mateo, CA 94403

 650.399.9659  
 [calmod@caltrain.com](mailto:calmod@caltrain.com)



# Caltrain Electrification Project

The project information line can be reached at 650.399.9659 or toll free at 800.660.4287.

The project e-mail is [calmod@caltrain.com](mailto:calmod@caltrain.com). Sign up for weekly construction updates can be found online at: [www.calmod.org/get-involved](http://www.calmod.org/get-involved).

## BURLINGAME CROSSING CLOSURE NOTICE | May, 2022

### CLOSURE MAPS

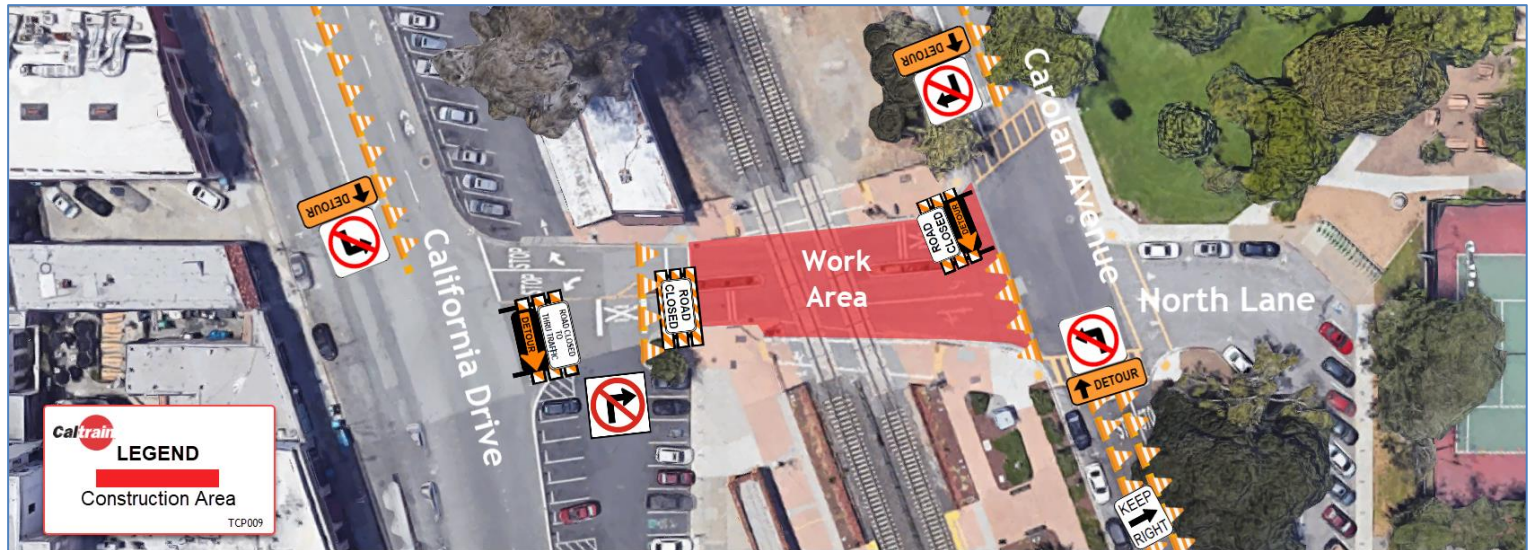
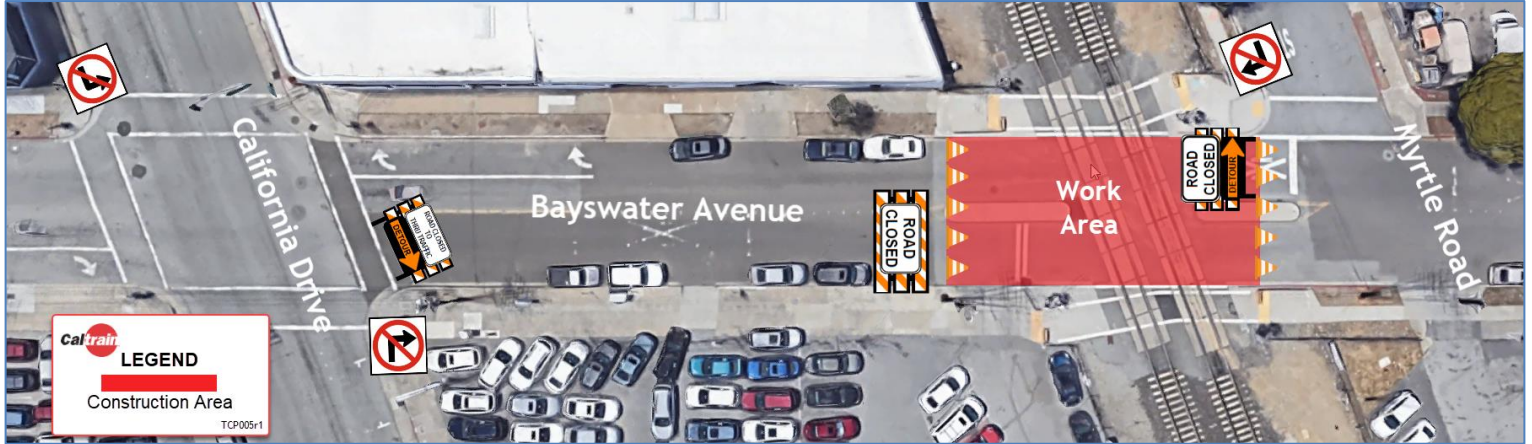

San Mateo, CA 94405

[calmod@caltrain.com](mailto:calmod@caltrain.com)

Para traducción llama al 1.800.660.4287  
如需翻譯,請電 1.800.660.4287  
Cần dịch thuật, xin gọi 1.800.660.4287

