

CALTRAIN ELECTRIFICATION



ALMA STREET at EAST MEADOW DRIVE CLOSURE NOTICE | August, 2020

UPCOMING ACTIVITIES AND LANE CLOSURE

Between the period of August 6 and August 7, Caltrain will be performing shrub removal and replanting work in Palo Alto that will require the temporary closure of the right southbound lane of Alma Street at East Meadow Drive. The temporary lane closure is required due to construction equipment and crews entering and exiting the Caltrain right-of-way from Alma Street.

Work will take place on August 6 through August 7 between 9:00 am to 4:00 pm

Construction signs and an illuminated directional sign will direct the merging of southbound vehicle traffic from the right lane into the left southbound lane of Alma Street. A flagger will be present at the entrance/exit gate at the Caltrain right-of-way north of East Meadow Drive to assist the directing of traffic and construction equipment entering and exiting the Caltrain right-of-way from Alma Street.

A lane closure map is provided on the reverse of this notice for vehicle and bicycle traffic.

CONSTRUCTION ACTIVITIES

During the closure, crews will remove portions of existing shrubbery along the Caltrain right-of-way and replace removed shrubbery with new plant material. The removal and replacement of plant materials will be supervised by an arborist as required by the City of Palo Alto.

Caltrain has established a dedicated project hotline and email for residents concerned about these potential impacts.

PROJECT OVERVIEW

Over the last decade, Caltrain has experienced a substantial increase in ridership and anticipates further increases in ridership demand as the Bay Area's population grows. Caltrain Electrification, scheduled to be operational by 2022, will electrify and upgrade the performance, operating efficiency, capacity, safety, and reliability of Caltrain's commuter rail service.

Caltrain electrification is a key component of the Caltrain Modernization Program and consists of replacing diesel-hauled with an electric train system for services between Fourth and King Street Station in San Francisco and the Tamien Station in San Jose. The project will include the installation of new electrical infrastructure and the purchase of electric trains.

CONTACT INFORMATION

Caltrain has established a project information line and project e-mail for Caltrain Electrification to record and respond to questions and comments from residents and stakeholders.

The project information line can be reached at **650.399.9659** or toll free at **800.660.4287**.

The project e-mail is calmod@caltrain.com

In addition, Caltrain has established a community outreach office at:

2121 S. El Camino Real
Suite A-100
San Mateo, CA 94403

Sign up for weekly construction updates can be found online at: www.calmod.org/get-involved



FOR MORE INFORMATION

 calmod.org

 Para traducción llama al 1.800.660.4287
如需翻譯,請電 1.800.660.4287
Cần dịch thuật, xin gọi 1.800.660.4287

CONTACT

MAIL: 2121 S. El Camino Real, Suite 300
San Mateo, CA 94403

 650.399.9659
 calmod@caltrain.com

Caltrain Electrification Project

ALMA STREET at EAST MEADOW DRIVE CLOSURE NOTICE | August, 2020

WORK SITE LOCATION MAP

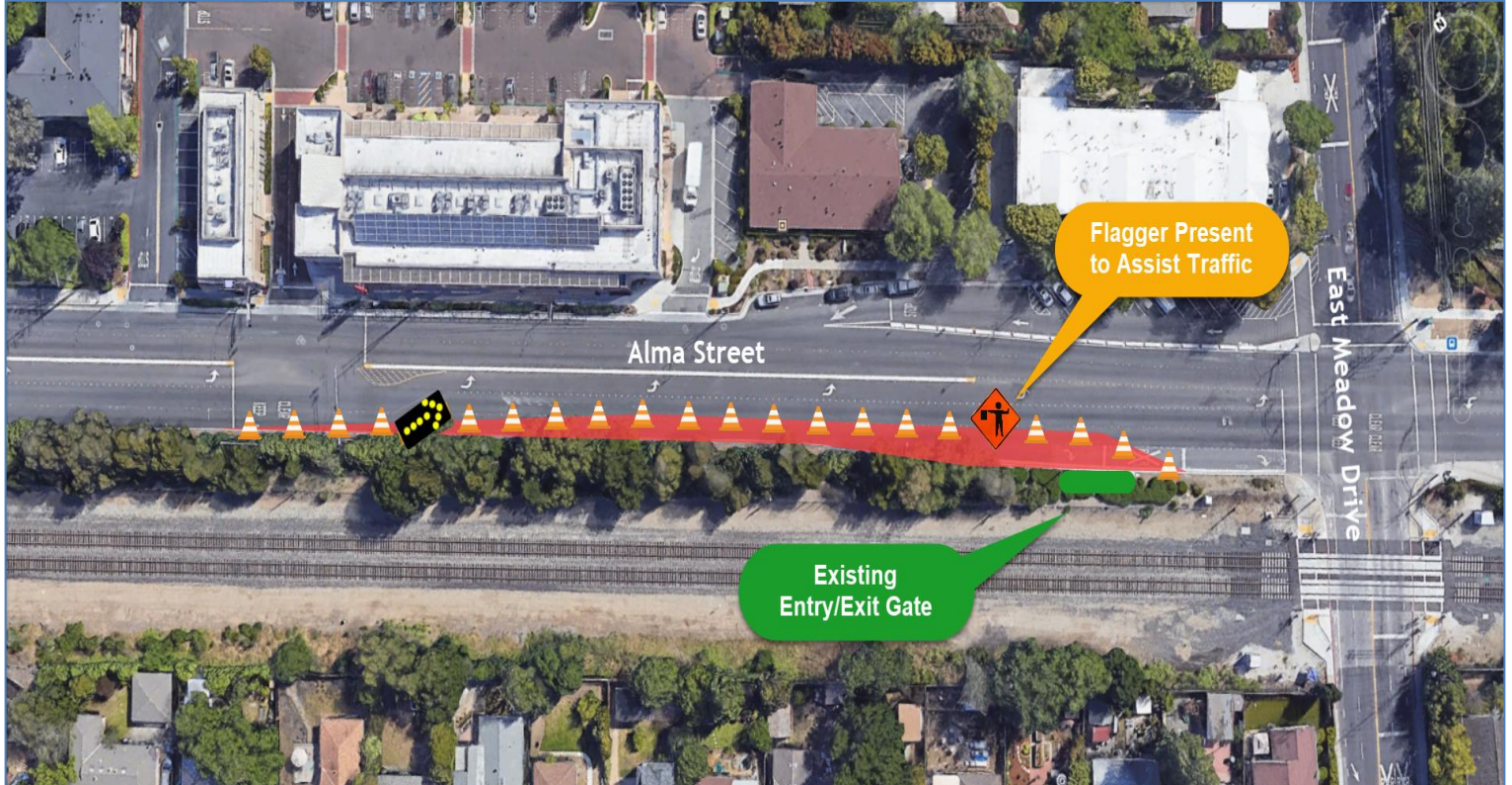



FOR MORE INFORMATION

 calmod.org

 Para traducción llama al 1.800.660.4287
如需翻譯,請電 1.800.660.4287
Cần dịch thuật, xin gọi 1.800.660.4287

CONTACT

MAIL: 2121 S. El Camino Real, Suite 300
San Mateo, CA 94403

 650.399.9659
 calmod@caltrain.com

